

# Route 87

*Updated: November 2011*

Upalco Route 86 to Ioka Jct. on Route 6, 1935 by Commission as a Federal-aid project.

1953 Description:

From Upalco on Route 86 easterly, via Ioka to Route 6.

**Approved by 1963 Legislature:**

1964 Description:

From SR-6 in Duchesne northerly, thence easterly via Altamont, thence southeasterly via Upalco thence east to SR-6 southwest of Roosevelt.

\*\*(\*A) Scanned) Commission Action July 31, 1964.

**1965 Legislature:**

(A portion of SR-35 5.9 miles north of Duchesne transferred to this route - a portion of SR-134 north to 2.9 miles south of Mountain Home transferred to this route - a portion of SR-221 from SR-134 easterly to SR-221 at Altamont transferred to this route - a portion of SR-86 from Altamont southerly to SR-6 south of Bridgeland transferred to this route.)

**1967 Legislature:** Description remains the same.

**1969 Legislature:** Description remains the same.

\*(B)

**1975 Legislature:** Description remains the same.

**1977 Legislature:** Description remains the same.

**1979 Legislature Description:**

From Route 40 in Duchesne northerly; thence easterly via Altamont; thence southeasterly via Upalco; thence east to Route 40 southwest of Roosevelt.

**1981 Legislature:** Description remains the same.

**1983 Legislature:** Description remains the same.

**1985 Legislature:** Description remains the same.

**1986 Legislature:** Description remains the same.

**1987 Legislature:** Description remains the same.

**1988 Legislature:** Description remains the same.

**1990 Legislature:** Description remains the same.

**1992 Legislature:** Description remains the same.

**1993 Legislature:** Description remains the same.

**1994 Legislature:** Description remains the same.

**1995 Legislature:** Description remains the same.

**1996 Legislature:** Description remains the same.

**1997 Legislature:** Description remains the same.

## Route 87 Cont.

### 1998 Legislative Description:

From Route 40 in Duchesne northerly; then easterly through Altamont; thence southeasterly through Upalco; then east to Route 40 southwest of Roosevelt.

1999 Legislature: Description remains the same.

2000 Legislature: Description remains the same.

2001 Legislature: Description remains the same.

2002 Legislature: Description remains the same.

2003 Legislature: Description remains the same.

2004 Legislature: Description remains the same.

2005 Legislature: Description remains the same.

2006 Legislature: Description remains the same.

2007 Legislature: Description remains the same.

2008 Legislature: Description remains the same.

2011 Legislature: Description remains the same.

\* Refers to resolution index page following.

\*\*Refers to Scanned Computer Resolution index on the following page.

## Route 87

### COUNTY/VOLUME & RESOLUTION NO.

A. Duchesne Co. 1/77	B. Duchesne Co. 4/10	
----------------------	----------------------	--

### DESCRIPTION OF RESOLUTION CHANGE

- (A). Extension - From junction with SR-6 to the junction of SR-134, thence northerly to the junction of SR-134 and SR-221, thence to the junction with SR-87.
- (B). Relocation/New Alignment - Northeast of Talmage.

U-35-7-87-10  
U-86-7-87-2205  
U-87-0am  
U-134-7-87-1-6  
U-221-7-87-2105

RESOLUTION

State Routes 35, 86, 87, 134, 221  
35 86 87 134 221

WHEREAS, to maintain continuity in the designation of State Routes in the Blue Bench area, north and east of Duchesne City; and

WHEREAS, Representatives of the Utah State Department of Highways, the governing bodies of Altonah, Bluebell, Mountain Home, Duchesne County and the Area Commissioner of the Utah State Road Commission conducted a field trip over all State Routes in the area; and

WHEREAS, there was mutual agreement of all agencies; and

WHEREAS, there will be no increase in State Route mileage,

NOW THEREFORE, be it resolved as follows:

1. That the State Route designation of 87 will commence at the present junction of State Route 6 and 35 in Duchesne City, traversing that portion of State Route 35 to the present junction of State Routes 35 and 134, thus deleting the designation of State Route 35 for this section of roadway, thence northerly traversing the existing portion of State Route 134 to the present junction of State Routes 134 and 221, south of Mountain Home, thus deleting the designation of State Route 134 for this section of roadway, thence continuing easterly traversing existing State Route 221 to its junction with present State Route 86, south of Altonah, thus deleting the State Route designation of 221, thence east, southeasterly and south, traversing existing State Route 86 to its junction with State Route 87, thus deleting the designation of State Route 86 for this section of roadway, thence east via existing State Route 87 to its junction with State Route 6 southwest of Roosevelt.

2. That with the re-designation of State Route 87, the following interim designations be adopted subject to the approval of the legislature:

State Route 35 - From Wanship on Route 2 via Peoa, Kamas and Tabiona to Route 87.

SR- 35,86,87  
134 & 221  
77

State Route 86 - From Route 6 southeast of Bridgeland, northerly via Bridgeland to Route 87.

State Route 87 - From Route 6 in Duchesne northerly, thence easterly via Altamont, thence southeasterly via Upalco thence east to Route 6 southwest of Roosevelt.

State Route 221 - From Route 87 in Altamont north to Altonah.

State Route 134 - From Route 87, north via Mountain Home to the Uintah and Ouray Indian Reservation Grazing Land Boundary.

State Route 199 - From Route 87, north to Bluebell, thence west to Route 87 east of Altamont.

3. That application be made to the U. S. Department of Commerce, Bureau of Public Roads, to have the Federal-aid Secondary Route designations changed to follow in continuity with the State Route designations.

Dated this 31st day of July, 1964.

STATE ROAD COMMISSION OF UTAH

Ernest Walsh  
Chairman

Fleming Delt  
Commissioner

Elmer Strong  
Commissioner

Ames K. Bagley  
Commissioner

\_\_\_\_\_  
Commissioner

ATTEST:

Lawrence W. Reed  
Secretary



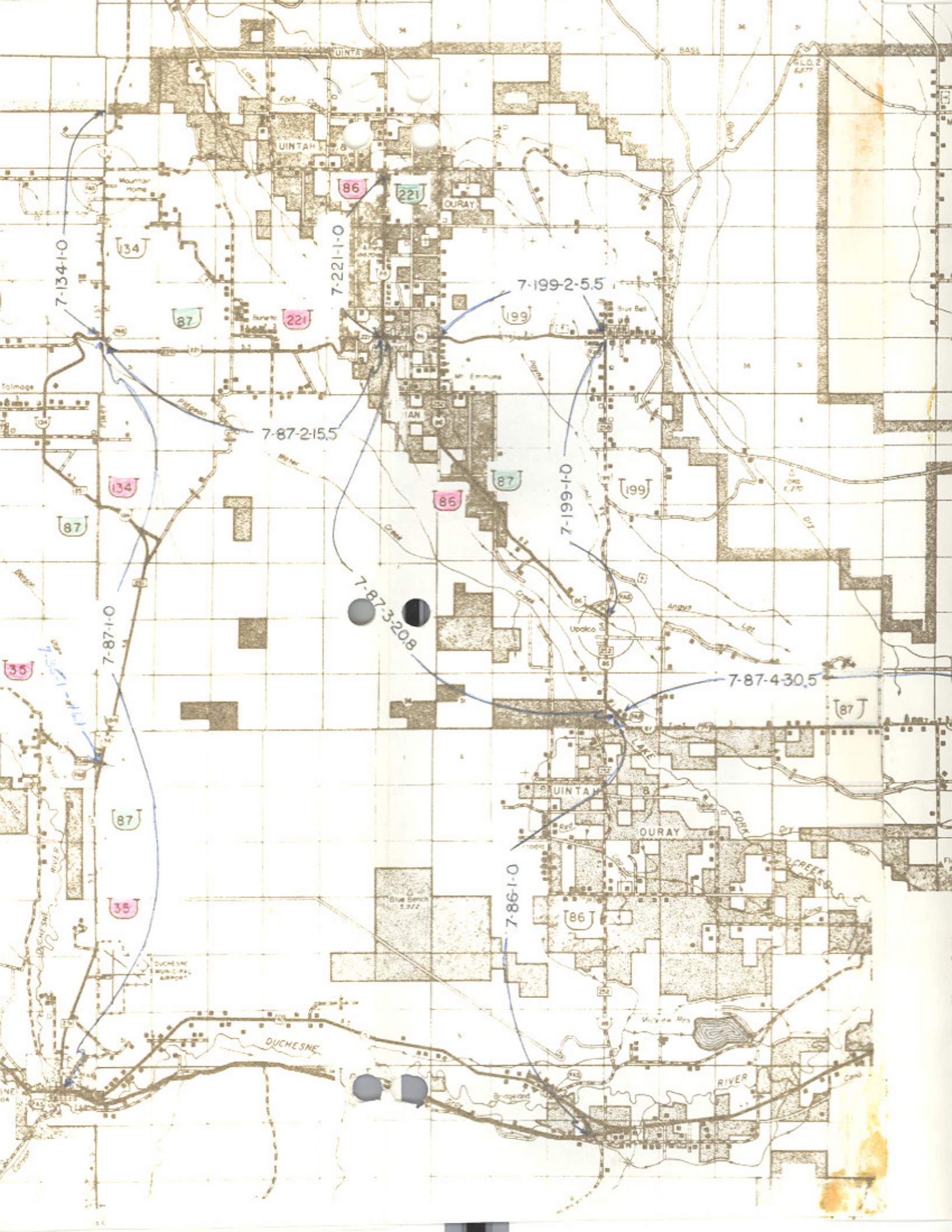



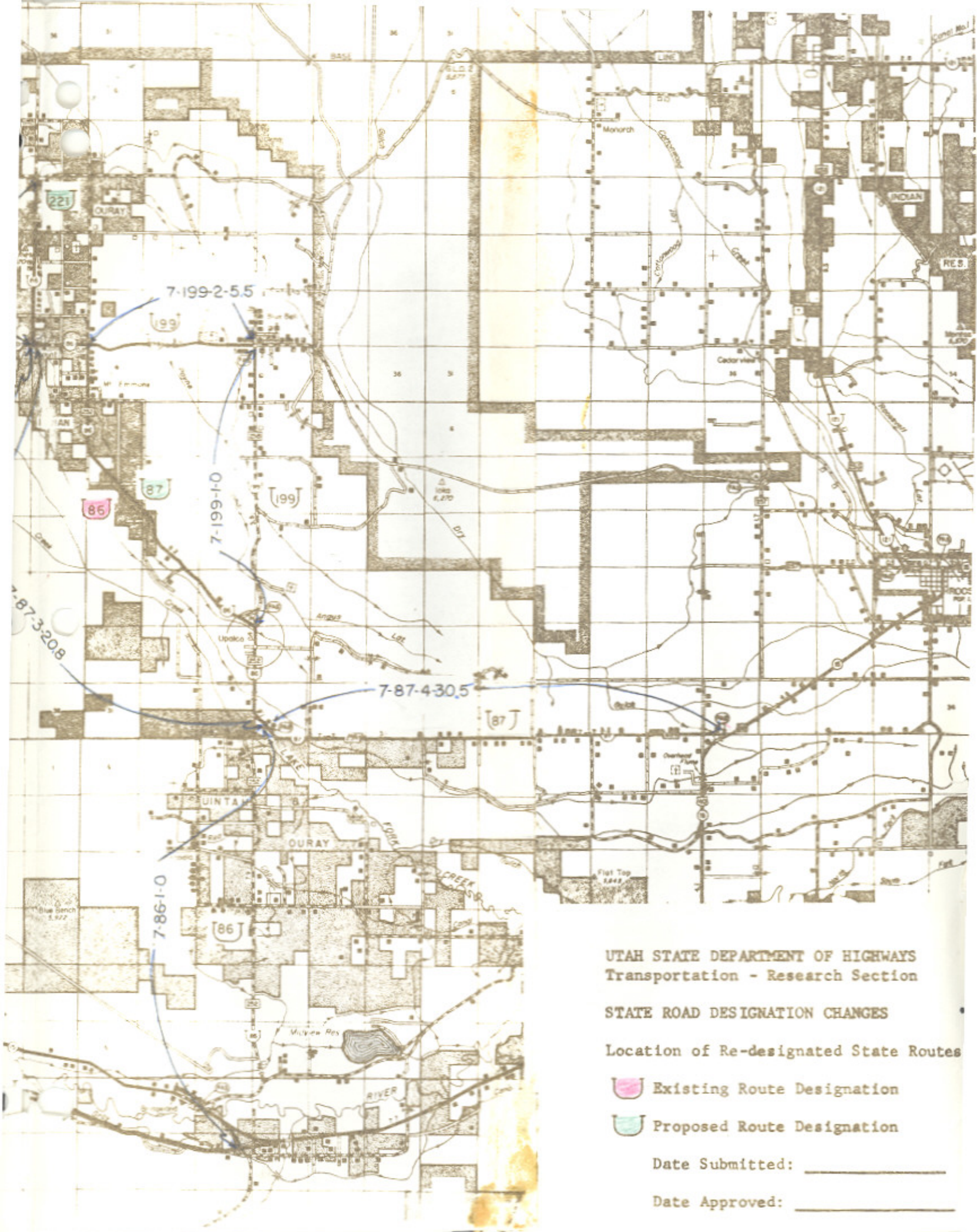



UTAH STATE DEPARTMENT OF HIGHWAYS  
 Transportation - Research Section

STATE ROAD DESIGNATION CHANGES  
 Location of Re-designated State Routes

-  Existing Route Designation
-  Proposed Route Designation

Date Submitted: \_\_\_\_\_

Date Approved: \_\_\_\_\_



Relinquishment of Realigned Highway  
Authority: Sec. 27-12-29, UCA, 1953, As Amended

RESOLUTION

State Route 87

WHEREAS, Project S-332(2) has resulted in the construction of a section of highway on new location northeast of Talmage in Duchesne County, and

WHEREAS, the old alignment of State Route 87 does not serve as a public roadway.

NOW THEREFORE, pursuant to the authority of Section 27-12-29, UCA, 1953, as amended, it is hereby resolved as follows:

That the old alignment of State Route 87 resulting from the construction of Project S-332(2) be abandoned,

That the ownership of the abandoned right-of-way be disposed of as related in the memorandums from Winston I. Neiman, Acting Plans & Estimates Engineer, and Edwin E. Lovelace, District Engineer,

That the memorandums from Winston I. Neiman and Edwin E. Lovelace, the Warranty Deed and Title Report from Duchesne County be hereby incorporated as a part of this submission,

That the map sheets illustrating the action taken be hereby incorporated as a part of this submission.

Dated this 3rd day of September, 1971.

STATE ROAD COMMISSION OF UTAH

Henry H. Church  
Chairman

B. J. [Signature]  
Vice-Chairman



RESOLUTION  
State Route 87  
Page 2

Francis Smith  
Commissioner

Ross W. Hunt  
Commissioner

Wagner Whitton  
Commissioner

ATTEST:

Lonnie A. Feenley  
Secretary

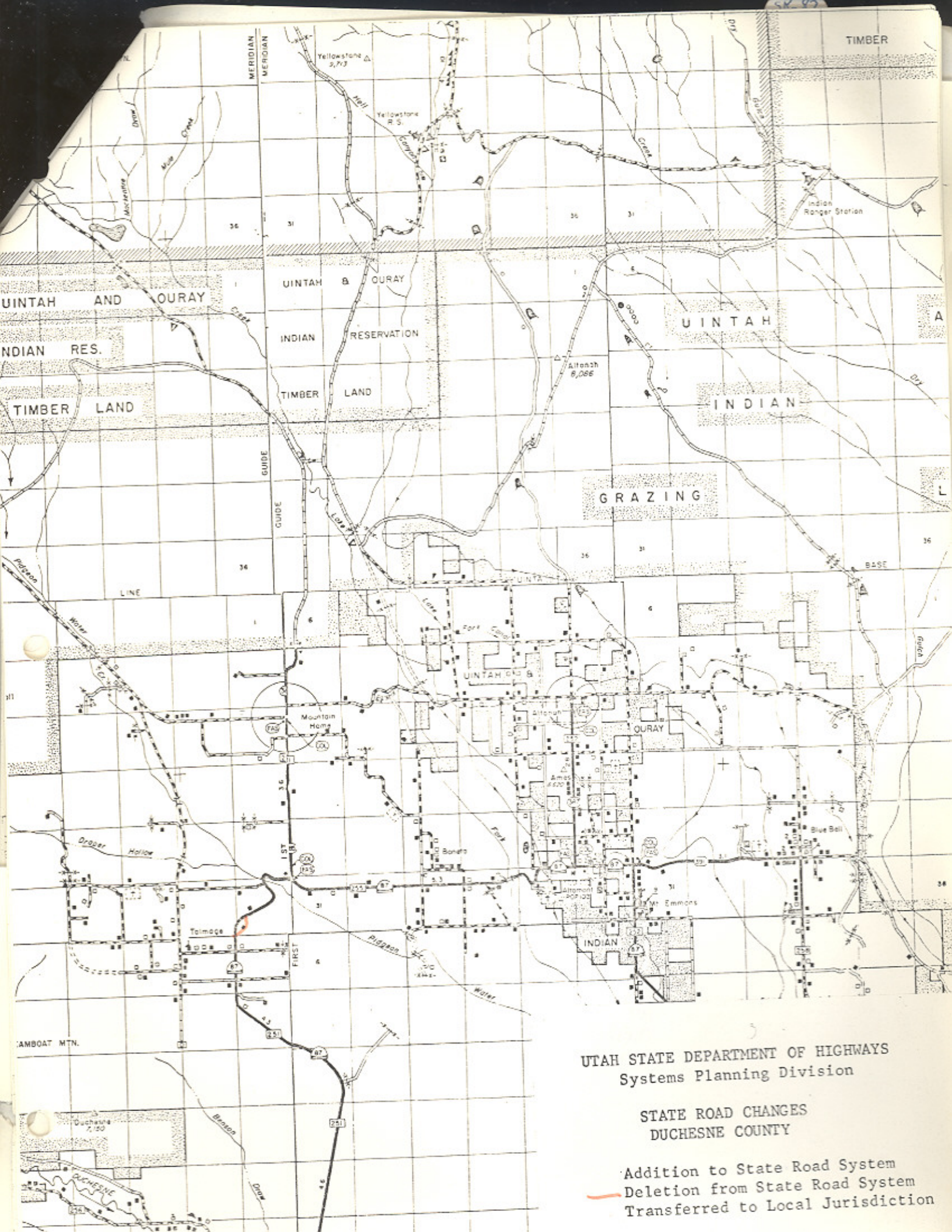

UTAH STATE DEPARTMENT OF HIGHWAYS  
Systems Planning Division

STATE ROAD CHANGES  
DUCHESNE COUNTY

- Addition to State Road System
- - - Deletion from State Road System
- Transferred to Local Jurisdiction



Memorandum

UTAH STATE DEPARTMENT OF HIGHWAYS

U-900

DATE: July 20, 1971

TO : Lester Jester  
Chief, Systems Planning Division

FROM : Winston I. Neiman *WIN*  
Acting Plans & Estimates Engineer

SUBJECT: Highway Project S-332(2), Old Highway Right of Way

Attached are copy of letter from the District 6 Engineer and a map showing, colored in red, the old highway which was bypassed in 1955. This old right of way had been used through prescriptive right and is no longer required.

Will you please prepare the necessary abandonment resolution for Commission action so that it may be recorded and the land revert to the adjacent property owner.

Attachments

cc: Max Williams

RECEIVED  
Utah State Department of Hiways  
Transportation Section

*J*

JUL 21 1971

AM PM

7,8,9,10,11,12,1,2,3,4,5,6

4

# Memorandum

UTAH STATE DEPARTMENT OF HIGHWAYS

253

DATE: 13 July 1971

TO : John W. Homer  
Plans & Estimates Engineer

FROM : Edwin E. Lovelace, District Engineer  
District Six

SUBJECT: Project S-332(2)  
Parcel 30

*EEL*

Mr. Calvin Workman of 3551 East Oaks Drive, Salt Lake City, Utah 84117, has acquired the James H. Wilson property near the Mountain Home Junction. In 1955, we realigned the highway in the area of the property now owned by Mr. Workman and vacated a portion of the old roadway.

As Mr. Workman has been paying taxes on the portion of the old roadway that lies within his property description and that portion of the old right of way no longer will be needed for future highway use, would you take the necessary action to have the road abandoned so that it may revert to Mr. Workman.

EEL/KCJ/sf

cc: Don W. Stahle, Asst. Chief, R/W Field Operations  
Max Williams, R/W Property Management Supervisor



7-19-71 EMB

7-20-71 To Dale Burningham



WARRANTY DEED  
In Duchesne County

Bet. Stas. 737+69 & 741+31

Description No. S332-30

Both Sides of Highway

Project No. S-332 (2)

James H. Wilson

the STATE ROAD COMMISSION OF UTAH

Duchesne

Land for highway known as Project No. S-332 situated in the SW $\frac{1}{4}$  SW $\frac{1}{4}$  of Section 36, T. 1 S., R. 5 W., U.S.M. The boundaries of said tract of land are described as follows:

Beginning at the NW corner of said SW $\frac{1}{4}$  SW $\frac{1}{4}$ ; thence East, 214 feet, more or less, along the north boundary line of said SW $\frac{1}{4}$  SW $\frac{1}{4}$ , to a point 60.0 feet radially distant southeasterly from the center line of survey of said project; thence Southwesterly, 400 feet, more or less, along the arc of a 1372.7 foot radius curve to the left, to the west boundary line of said Section 36 (Note: Tangent to said 1372.7 foot radius curve at its point of beginning bears S. 40° 47' W.); thence North 330 feet, more or less, along said west boundary line to the point of beginning as shown on the official map of said project on file in the office of the State Road Commission of Utah. Above described tract of land contains 0.73 acres, more or less, of which 0.27 acre, more or less, is now occupied by the existing highway. Balance 0.46 acres, more or less.

The grantors also hereby grant to the grantee permission to locate and construct within the grantors land and outside the limits of the highway right of way all irrigation and/or waste water ditches made necessary by the construction of said project. After the above described ditches are constructed, the grantee is thereafter relieved of all responsibility for the maintenance of said ditches.

Any and all water rights pertaining to the above described land are hereby reserved by the grantor, and the grantee shall not be liable for any water assessments now due or which shall become due.

The grantors hereby reserve all gas, oil, and mineral rights and agree not to extract said gas, oil, or minerals from the surface of the above described tract, and the grantors further agree not to interfere with the use of said tract for highway purposes or purposes incidental thereto.

Prepared by W.I.N., 2/3/55

Proof read by W.F. B. B., 3/12/55

Checked by W.B.N., 2/11/55

Typed by V.A., 3/16/55





File

727+44 SEC. COR. 1.5' RT.

REG. SHOW

727+44

728+00

727+00 J. 1117 X-1119

728+45 T.B.A. P. 229' RT. AND P.A. 224' RT.

729+03 P.A. 138.0' RT.

729+03

730+00

730

730+00 LIGHT DRAINAGE

P.C. 731+71.4

P.O. ST. 732+82 P. X-1119

P.O. 733+50 P. X-1119

S.E. 1/4 S.E. 1/4 SEC. 35

735

PROPERTY TO REVERT TO CALVIN (PRESENT OWNER) WORKMAN (OWNER)

STATION	IN PLACE	LIST OF ST
727+50		
728+00		
729+00		
730+00		
731+00		
732+00		
733+00		
734+00		
735+00		

D=67  
E=40  
L=123  
L=152

PRIS.

729+03 S.A. 158.0' RT.

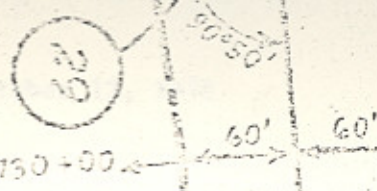

P.O. 731+71.4

P.O. ST. 732+00  
E. WANG

P.O. 728+60  
DIX-HOLLO

S.E. 1/4 S.E. 1/4  
SEC. 158

735

$A = 619.31 \text{ FT.}$   
 $B = 46.31 \text{ FT.}$   
 $C = 1930.7 \text{ FT.}$   
 $L = 822.7$   
 $L = 1537.9$

 PROPERTY TO REVERT TO CALVIN (PRESENT WORKMAN OWNER)

LIST OF STRUCTURES

STATION	IN PLACE	REQUIRD	REMARKS
729+03			
729+04			
729+05			
729+06			
729+07			
729+08			
729+09			
729+10			
729+11			
729+12			
729+13			
729+14			
729+15			
729+16			
729+17			
729+18			
729+19			
729+20			
729+21			
729+22			
729+23			
729+24			
729+25			
729+26			
729+27			
729+28			
729+29			
729+30			



DATE	BY



UTAH STATE DEPARTMENT OF HIGHWAYS

✓ cc: Howard B. Leatham, Engineer for Planning & Programming

Information sent to: Edwin E. Lovelace, District #6 Engineer

Jerry Fenn	Maurice Richey	Ellen Wandell	Charles Bertolina
Ralph Murdock	Clarence Stephens	Harold Brown	Jim West
Dean Steed	Evelyn Crill	Ray Behling	Don Jensen
Porter M. Gooch	Wallace Liddle	Bonnie Garcia	Clarence Bywater
Keith Rosevear	David Sargent	John W. Homer	Ken Riddle
Robert Walsh	Art Geurts	Chauncey Powis	Winston Neiman
Lillian Witkowski	Robin Hood	E. Paul Gilgen	Robert Weadon
Mary Decker	Ezra Christensen	Bert Kros	

October 12, 1971

~~Mr. Wilmer Murray, Chairman  
Duchesne County Commission  
Duchesne County Courthouse  
Duchesne, Utah 84021~~

Dear Commissioner Murray:

Subject: Deletion of a portion of the old alignment of State Route 87  
in Duchesne County

Effective September 24, 1971, the Utah State Road Commission adopted a resolution to abandon a portion of the old alignment of State Route 87 created by the construction of Project S-332(2) northeast of Talmage in Duchesne County.

Attached is a copy of the resolution and a location map.

Very truly yours,

L. R. Jester, P.E.  
Chief, Systems Planning Division

Attachment

C  
O  
P  
Y